

Soils Map

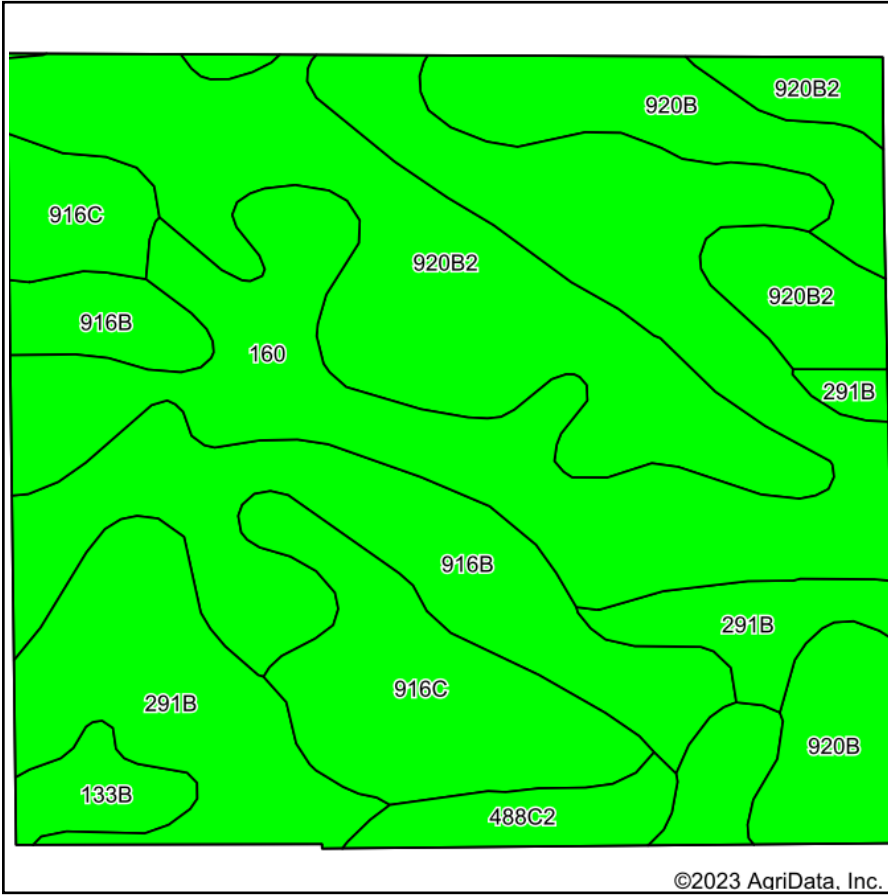

Soils data provided by USDA and NRCS.

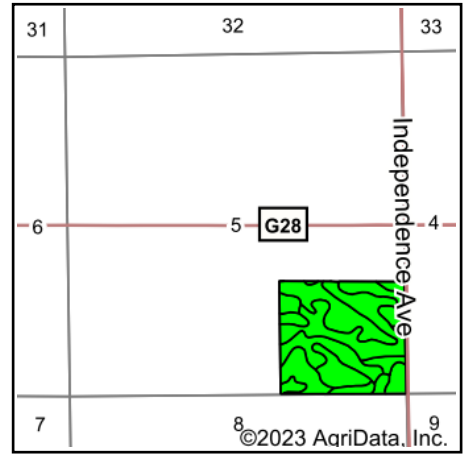

State: **Iowa**
 County: **Muscatine**
 Location: **8-76N-3W**
 Township: **Seventy-Six**
 Acres: **78.53**
 Date: **10/27/2023**



Maps Provided By:



Area Symbol: IA139, Soil Area Version: 29

Code	Soil Description	Acres	Percent of field	CSR2 Legend	Non-Irr Class *c	CSR2**	CSR	
160	Walford silt loam, 0 to 2 percent slopes	19.96	25.4%		IIw	82	65	
920B2	Tama silt loam, sandy substratum, 2 to 5 percent slopes, eroded	16.64	21.2%		IIe	89	77	
916B	Downs silt loam, sandy substratum, 2 to 5 percent slopes	11.53	14.7%		IIe	88	77	
291B	Atterberry silt loam, 2 to 5 percent slopes	9.57	12.2%		IIe	85	90	
916C	Downs silt loam, sandy substratum, 5 to 9 percent slopes	8.74	11.1%		IIIe	82	65	
920B	Tama silt loam, sandy substratum, 2 to 5 percent slopes	7.25	9.2%		IIe	92	82	
133B	Colo-Ely complex, 0 to 5 percent slopes	2.85	3.6%		IIw	86	75	
488C2	Newvienna silt loam, 5 to 9 percent slopes, moderately eroded	1.99	2.5%		IIIe	77	71	
Weighted Average						2.14	85.7	74.4

**IA has updated the CSR values for each county to CSR2.

*c: Using Capabilities Class Dominant Condition Aggregation Method

Soils data provided by USDA and NRCS.